

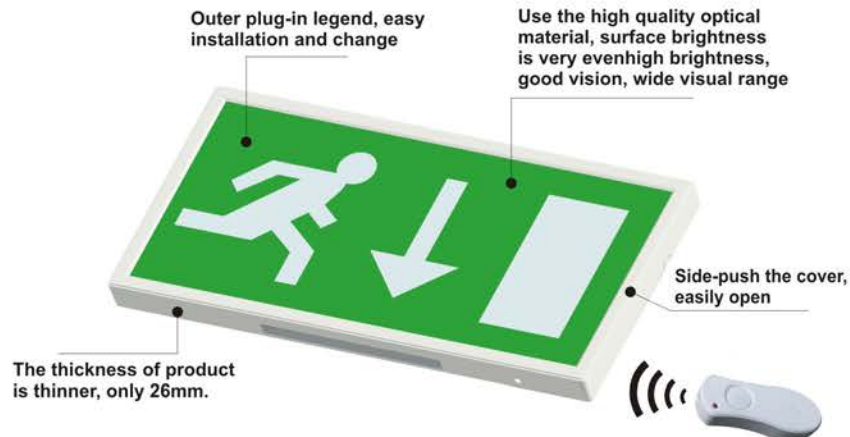

A Professional Manufacturer of  
**Emergency Light**  
Since 1984



## Emergency Exit Box



### DP-3218L LED Version

#### Materials

polycarbonate body and diffuser

#### Specifications

- 3.6V 2Ah Ni-MH batteries
- 20+6pcs White LED
- Protection level IP20
- Emergency operation time 3 hours
- Product size(LxWxH): 394x26x195mm
- Supplied including LED
- DC or AC/DC operated
- CE

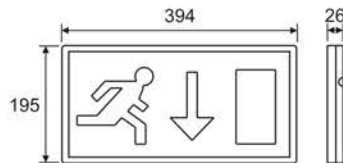

## Emergency Twinspot



### DP/NM3/108L/65 LED Version

#### Materials

polycarbonate body and diffuser

#### Specifications

- 6V 7Ah Lead acid battery
- 54+54pcs White LED
- Protection level IP65
- Emergency operation time 3 hours
- Product size(LxWxH): 300x70x294mm
- Supplied including LED
- DC operated
- CE

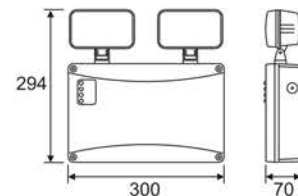



### DP-6228M

#### Materials

polycarbonate body and diffuser

#### Specifications

- 3.6V 4.5Ah Ni-Cd batteries
- Fluorescent lamp 2D28W
- Protection level IP65
- Emergency operation time 3 hours
- Product size(LxWxH): Ø343x106mm
- Supplied including lamp
- AC or AC/DC operated
- CE

### DP-6280L

#### LED Version

#### Materials

polycarbonate body and diffuser

#### Specifications

- 3.6V 1.5Ah Ni-Cd batteries
- 300pcs White LED
- Protection level IP65
- Emergency operation time 3 hours
- Product size(LxWxH): Ø343x106mm
- Supplied including LED
- AC or AC/DC operated
- CE



### DP-633L

#### LED Version

#### Materials

polycarbonate body and diffuser

#### Specifications

- 3.6V 1.5Ah Ni-Cd batteries
- 27pcs White LED
- Protection level IP65
- Emergency operation time 3 hours
- Product size(LxWxH): 352x110x57mm
- Supplied including LED
- DC or AC/DC operated
- CE

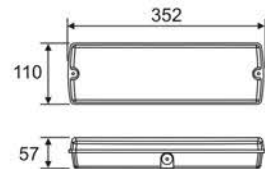

**DP-630**



IP65

### Materials

polycarbonate body and diffuser

### Specifications

- 2.4V 4.5Ah Ni-Cd batteries
- Fluorescent lamp T5 8W
- Protection level IP65
- Emergency operation time 3 hours
- Product size(LxWxH): 352x117x76mm
- Supplied including lamp
- DC or AC/DC operated
- CE

**DP-630M2**



IP65

### Materials

polycarbonate body and diffuser

### Specifications

- 2.4V 4.5Ah Ni-Cd batteries
- Fluorescent lamp T5 2x8W
- Protection level IP65
- Emergency operation time 3 hours
- Product size(LxWxH): 352x117x76mm
- Supplied including lamp
- DC or AC/DC operated
- CE

**DP-630LED  
LED Version**



IP65

### Materials

polycarbonate body and diffuser

### Specifications

- 3.6V 1.8Ah Ni-Cd batteries
- 10pcs White 5050 SMD LED
- Protection level IP65
- Emergency operation time 3 hours
- Product size(LxWxH): 352x117x76mm
- Supplied including LED
- DC or AC/DC operated
- CE

**DP-650**



IP65

### Materials

polycarbonate body and diffuser

### Specifications

- 2.4V 4.5Ah Ni-Cd batteries
- Fluorescent lamp T5 8W
- Protection level IP65
- Emergency operation time 3 hours
- Product size(LxWxH): 345x107x75mm
- Supplied including lamp
- DC or AC/DC operated
- CE

**DP-650LED  
LED Version**



IP65

### Materials

polycarbonate body and diffuser

### Specifications

- 3.6V 2.0Ah Ni-Cd batteries
- 50pcs White LED
- Protection level IP65
- Emergency operation time 3 hours
- Product size(LxWxH): 345x107x75mm
- Supplied including LED
- DC or AC/DC operated
- CE

**DP-633A**



IP65

### Materials

polycarbonate body and diffuser

### Specifications

- 3.6V 2.0Ah Ni-Cd batteries
- Fluorescent lamp T5 8W
- Protection level IP65
- Emergency operation time 3 hours
- Product size(LxWxH): 352x110x57mm
- Supplied including lamp
- DC or AC/DC operated
- CE

**DP/NM3/120L**  
LED Version



### Materials

Steel body (white or black)  
Polycarbonate lamp heads

### Specifications

- 12V 7Ah Lead acid battery
- 60+60pcs White LED
- Emergency operation time 4 hours
- Product size(LxWxH): 305x70x306mm
- Supplied including LED
- DC operated
- CE

**DP/NM3/20WD**



### Materials

Steel body (white or black)  
Polycarbonate adjustable lamp heads

### Specifications

- 12V 12Ah Lead acid batteries
- 2x20W Halogen bulb
- Emergency operation time 3 hours
- Product size(LxWxH): 350x110x275mm
- Supplied including lamp
- DC operated
- CE

**DP-268LED**  
LED Version



### Materials

Steel body  
Polycarbonate adjustable lamp heads

### Specifications

- 4.8 4.5Ah Ni-Cd batteries
- 40+40pcs White LED
- Emergency operation time 3 hours
- Product size(LxWxH): 280x50x250mm
- Supplied including LED
- DC operated
- CE

**DP/NM3/20W**



### Materials

Steel body (white or black)  
Polycarbonate adjustable lamp heads

### Specifications

- 2x12V 7Ah Lead acid batteries
- 2x20W Halogen bulb
- Emergency operation time 3 hours
- Product size(LxWxH): 305x70x306mm
- Supplied including lamp
- DC operated
- CE

**DP/NM3/55W**



### Materials

Steel body (white or black)  
Polycarbonate adjustable lamp heads

### Specifications

- 2x12V 7Ah Lead acid batteries
- 2x55W Halogen bulb
- Emergency operation time 1 hours
- Product size(LxWxH): 305x70x306mm
- Supplied including lamp
- DC operated
- CE

**DP-126L**



LED Version

**DP-127L**



### Materials

Steel body  
Plastic adjustable lamp heads  
(ABS back, AS diffuser)

### Specifications

- 4V 4.5Ah Lead acid battery
- 2x1W high power LED
- Emergency operation time about 12 hours
- Product size(LxWxH): 270x85x305mm(126L)  
270x85x275mm(127L)
- Supplied including LED
- DC operated



DP-2D28W



### Materials

polycarbonate body and diffuser

### Specifications

- 3.6V 4.5Ah Ni-Cd batteries
- Fluorescent lamp 2D28W
- Emergency operation time 3 hours
- Product size(LxWxH): Ø410x110mm
- Supplied including lamp
- AC or AC/DC operated
- CE

DP-1004CB



IP65

### Materials

polycarbonate body and diffuser

### Specifications

- 2.4V 4.5Ah Ni-Cd batteries
- Fluorescent lamp 2D16W
- Protection level IP65
- Emergency operation time 3 hours
- Product size(LxWxH): Ø220x100mm
- Supplied including lamp
- AC or AC/DC operated
- CE

DP-1004WW



DP-1003CB



IP65

### Materials

polycarbonate body and diffuser

### Specifications

- 3.6V 4.5Ah Ni-Cd batteries
- Fluorescent lamp 2D28W
- Protection level IP65
- Emergency operation time 3 hours
- Product size(LxWxH): Ø320x100mm
- Supplied including lamp
- AC or AC/DC operated
- CE

DP-1003WW



DP-1001CB

IP65

### Materials

polycarbonate body and diffuser

### Specifications

- 3.6V 4.5Ah Ni-Cd batteries
- Fluorescent lamp 2D28W
- Protection level IP65
- Emergency operation time 3 hours
- Product size(LxWxH): 320x320x100mm
- Supplied including lamp
- AC or AC/DC operated
- CE

DP-1001WW



**DP-630L**  
LED Version



IP65

### Materials

polycarbonate body and diffuser

### Specifications

- 3.6V 1.5Ah Ni-Cd batteries
- 10pcs White 5050 SMD LED
- Protection level IP65
- Emergency operation time 3 hours
- Product size(LxWxH): 352x117x76mm
- Supplied including LED
- DC or AC/DC operated
- CE

**DP-633L**  
LED Version



IP65

### Materials

polycarbonate body and diffuser

### Specifications

- 3.6V 1.5Ah Ni-Cd batteries
- 27pcs White LED
- Protection level IP65
- Emergency operation time 3 hours
- Product size(LxWxH): 352x110x57mm
- Supplied including LED
- DC or AC/DC operated
- CE

**DP-650LED**  
LED Version



IP65

### Materials

polycarbonate body and diffuser

### Specifications

- 3.6V 2.0Ah Ni-Cd batteries
- 50pcs White LED
- Protection level IP65
- Emergency operation time 3 hours
- Product size(LxWxH): 345x107x75mm
- Supplied including LED
- DC or AC/DC operated
- CE

**DP-633EXIT**  
LED Version



IP65

### Materials

polycarbonate body and diffuser

### Specifications

- 3.6V 1.5Ah Ni-Cd batteries
- 27pcs White LED
- Protection level IP65
- Emergency operation time 3 hours
- Product size(LxWxH): 352x110x215mm
- Supplied including LED
- DC or AC/DC operated
- CE

**DP-630EXIT**



IP65

### Materials

polycarbonate body and diffuser

### Specifications

- 2.4V 4.5Ah Ni-Cd batteries
- Fluorescent lamp T5 8W
- Protection level IP65
- Emergency operation time 3 hours
- Product size(LxWxH): 352x117x200mm
- Supplied including lamp
- DC or AC/DC operated
- CE

**DP-680EXIT**



IP65

### Materials

polycarbonate body and diffuser

### Specifications

- 2.4V 4.5Ah Ni-Cd batteries
- Fluorescent lamp T5 8W
- Protection level IP65
- Emergency operation time 3 hours
- Product size(LxWxH): 352x95x190mm
- Supplied including lamp
- DC or AC/DC operated
- CE

**DP-2338**  
LED Version



### Materials

polycarbonate body and diffuser

### Specifications

- 3.6V 1.5Ah Ni-Cd batteries
- 27pcs White LED
- Emergency operation time 3 hours
- Product size(LxWxH): 405x208x55mm
- Supplied including LED
- DC or AC/DC operated
- CE

**DP-338L**  
LED Version



### Materials

steel body and polycarbonate panel

### Specifications

- 3.6V 1.5Ah Ni-Cd batteries
- 10pcs White 5050 SMD LED
- Emergency operation time 3 hours
- Product size(LxWxH): 390x190x60mm
- Supplied including LED
- DC or AC/DC operated
- CE

**DP-318**



### Materials

steel body and polycarbonate panel

### Specifications

- 2.4V 4.5Ah Ni-Cd batteries
- Fluorescent lamp T5 8W
- Emergency operation time 3 hours
- Product size(LxWxH): 390x190x60mm
- Supplied including lamp
- DC or AC/DC operated
- CE

**DP-318-C**



### Materials

steel body and polycarbonate panel

### Specifications

- 2.4V 4.5Ah Ni-Cd batteries
- Fluorescent lamp T5 8W
- Emergency operation time 3 hours
- Product size(LxWxH): 390x190x60mm
- Supplied including lamp
- DC or AC/DC operated
- CE

**DP-318LED**  
LED Version



### Materials

steel body and polycarbonate panel

### Specifications

- 3.6V 1.5Ah Ni-Cd batteries
- White LED
- Emergency operation time 3 hours
- Product size(LxWxH): 390x190x60mm
- Supplied including LED
- DC or AC/DC operated
- CE



## Emergency Exit Box

DP-968



White LED

Green LED

### Materials

Aluminum alloy body  
Double sided edge lit acrylic blade with legends

### Specifications

- 3.6V 600mh Ni-Cd batteries
- White LED or Green LED
- Emergency operation time 3 hours
- Product size(LxWxH): 400x250x30mm
- Supplied including LED
- AC/DC operated
- CE

DP-989



### Materials

Steel body  
Double sided edge lit acrylic blade with legends

### Specifications

- 3.6V 800mh Ni-Cd batteries
- White LED
- Emergency operation time 3 hours
- Product size(LxWxH): 353x257x34mm
- Supplied including LED
- AC/DC operated
- CE

DP-988



### Materials

Steel body  
Double sided edge lit acrylic blade with legends

### Specifications

- 4.8V 800mh Ni-Cd batteries
- White LED
- Emergency operation time 3 hours
- Product size(LxWxH): 305x225x45mm
- Supplied including LED
- AC/DC operated
- CE

## Emergency Exit Box

DP-808EXIT-B



### Materials

Steel body  
Double sided edge lit acrylic blade with legends

### Specifications

- 4.8V 800mh Ni-Cd batteries
- White LED
- Emergency operation time 3 hours
- Product size(LxWxH): 410x260x135mm
- Supplied including LED
- AC/DC operated
- CE

DP-968



### Materials

Aluminum alloy body  
Double sided edge lit acrylic blade with legends

### Specifications

- 3.6V 600mh Ni-Cd batteries
- White LED or Green LED
- Emergency operation time 3 hours
- Product size(LxWxH): 400x250x30mm
- Supplied including LED
- AC/DC operated
- CE

DP-630EXIT-A



### Materials

polycarbonate body and diffuser  
Double sided edge lit acrylic blade with legends

### Specifications

- 2.4V 4.5Ah Ni-Cd batteries
- Fluorescent lamp T5 8W
- Emergency operation time 3 hours
- Product size(LxWxH): 352x117x240mm
- Supplied including lamp
- DC or AC/DC operated
- CE

DP-928



**Specifications**

- Emergency pattern: AC/DC, AC or DC
- Input: 220V~240VAC 50/60Hz
- Output: 109pcs White LED(3500K / 6500K)
- Operation time: 3 hours
- Built-in battery: 3.6V 3Ah Ni-Cd
- Product size(LxWxH):  
PCB housing: Ø41x230mm  
Battery housing: Ø41x188mm  
LED tray: Ø173mm
- CE

DP-2WLED



**Specifications**

- Emergency pattern: AC/DC, AC or DC
- Input: 220V~240VAC 50/60Hz
- Output: 2W LED
- Operation time: 3 hours
- Built-in battery: 3.6V 3Ah Ni-Cd
- Product size(LxWxH):  
PCB housing: Ø41x230mm  
Battery housing: Ø41x188mm  
LED tray: Ø140mm or Ø85mm
- CE

DP-30WL



**Specifications**

- Emergency pattern: DC
- Input: 220V~240VAC 50/60Hz
- Output: 5~30W LED Tube
- Operation time: 3 hours
- External connection battery:  
12V 4.5Ah Ni-Cd
- Product size(LxWxH):  
PCB housing: 290x32x27mm  
Battery pack: 295x65x32mm
- CE

DP-1WLED



**Specifications**

- Emergency pattern: AC or DC
- Input: 220V~240VAC 50/60Hz
- Output: 1W LED
- Operation time: 3 hours
- Built-in battery: 3.6V 1.5Ah Ni-Cd
- Product size(LxWxH):  
PCB housing: Ø31x177mm  
Battery housing: Ø31x149mm  
LED tray: Ø45mm
- CE

DP-3WLED



**Specifications**

- Emergency pattern: AC/DC, AC or DC
- Input: 220V~240VAC 50/60Hz
- Output: 3W LED
- Operation time: 3 hours
- Built-in battery: 3.6V 3Ah Ni-Cd
- Product size(LxWxH):  
PCB housing: Ø41x230mm  
Battery housing: Ø41x188mm  
LED tray: Ø70mm
- CE

DP-5WLED



**Specifications**

- Emergency pattern: AC/DC, AC or DC
- Input: 220V~240VAC 50/60Hz
- Output: 5W LED
- Operation time: 3 hours
- Built-in battery: 3.6V 4.5Ah Ni-Cd
- Product size(LxWxH):  
PCB housing: Ø41x230mm  
Battery housing: Ø41x188mm  
LED tray: Ø78mm
- CE

### 2D28W SMT



#### Specifications

- Emergency pattern: AC/DC
- Input: 220V~240VAC 50/60Hz
- Output: 28W(2D) Fluorescent lamp
- Operation time: 3 hours
- External connection battery: 3.6V 4.5Ah Ni-Cd
- Product size(LxWxH):  
PCB housing: 123x80x32mm  
Battery pack: Ø37x220mm
- CE

### SAX3HF



#### Specifications

- Emergency pattern: DC
- Input: 220V~240VAC 50/60Hz
- Output: T8 4~36W Fluorescent lamp
- Operation time: 3 hours
- External connection battery: 3.6V 4.5Ah Ni-Cd
- Product size(LxWxH):  
PCB housing: 151x43x30mm  
Battery pack: Ø37x220mm
- CE

### ETLV910



#### Specifications

- Emergency pattern: DC, AC/DC (with AC ballast)
- Input: 220V~240VAC 50/60Hz
- Output: 50W Halogen
- Operation time: 1~3 hours
- External connection battery: 6V~12V 4.5Ah Ni-Cd
- Product size(LxWxH):  
PCB housing: 198x52x34mm  
Ballast: 108x38x27mm  
Battery pack: Ø32x(180+120)mm
- CE

### MCT-36W



### MCT-58W



#### Specifications

- Emergency pattern: DC
- Input: 220V~240VAC 50/60Hz
- Output: T8 36W / 58W Fluorescent lamp
- Operation time: 3 hours
- External connection battery: 3.6V 4.5Ah / 4.8V 4.5Ah Ni-Cd
- Product size(LxWxH):  
Emergency pack: 210x48x32mm  
Battery pack: Ø37x(220 or 277)mm
- CE

### DP-2D28W

#### Emergency pack



#### Specifications

- Emergency pattern: AC/DC
- Input: 220V~240VAC 50/60Hz
- Output: 28W(2D) Fluorescent lamp
- Operation time: 3 hours
- External connection battery: 4.8V 4.5Ah Ni-Cd
- Product size(LxWxH): 200x200x80mm
- CE

### DP-2D38W

#### Emergency pack



#### Specifications

- Emergency pattern: AC/DC
- Input: 220V~240VAC 50/60Hz
- Output: 38W(2D) Fluorescent lamp
- Operation time: 3 hours
- External connection battery: 3.6V 4.5Ah Ni-Cd
- Product size(LxWxH): 210x225x80mm
- CE